

FIDLOCK®

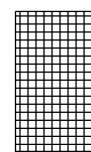
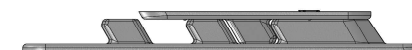
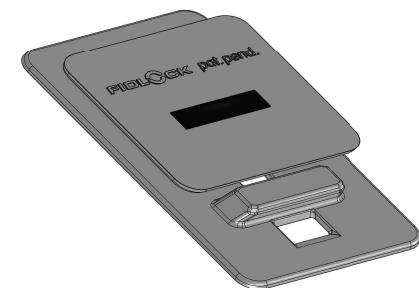
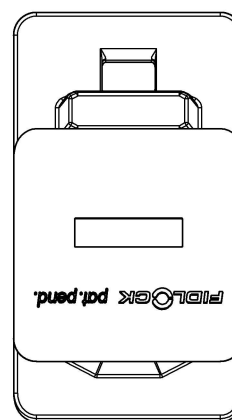
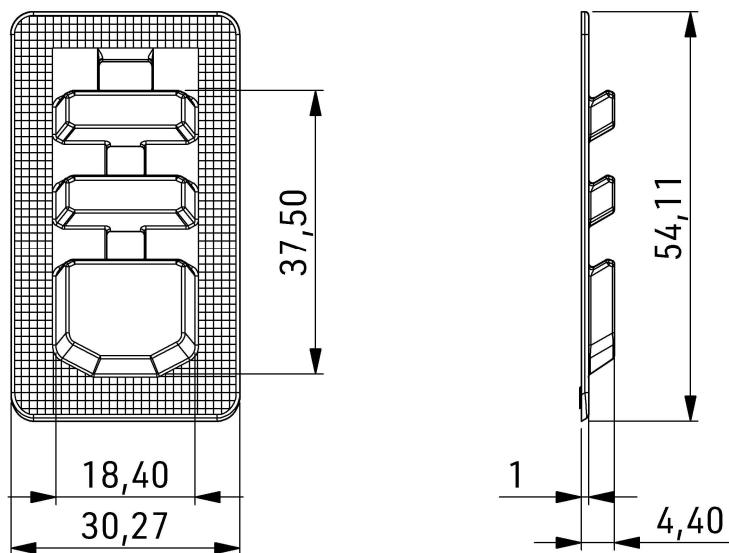
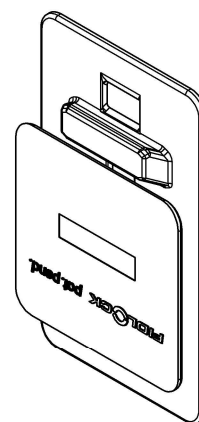
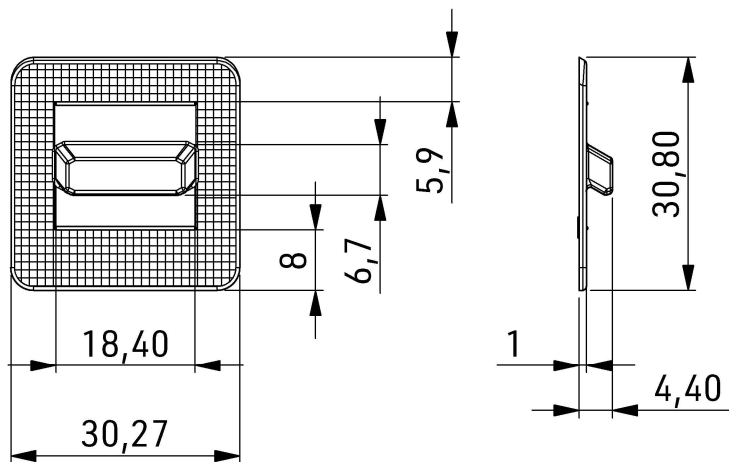

Stitching area

Proceed like stitching zipper
Use a zipper presser foot and stitch length 2-3 mm
(For securing the thread we recommend choosing a position next to the Fidlock part. Otherwise stability could be reduced.)

PRODUCT	Stripe X3 Flex
APPLICATION	sewable
OPENING	lifting
MATERIAL	TPU, NdFeB, Epoxy
COLOUR	
COLORABLE	only black
WEIGHT	8 g
LOAD CAPACITY	-
GENERAL NOTES	stitchable, weldable, shore hardness: 85S

ARTICLE NO.	01312-000002(BLK)
SCALE	1:1
DATE	14.05.2021
AUTHOR	SO

patented technology.