

Product	MINI TURN set handle F alu 40
Opening	Turn
Material	aluminium / PA66-GF / steele / NdFeB
* Material thicknesses	1,0mm - 2,6mm
Color	aluminium
Weight	40 g
Load capacity	44 kg
Assambly Guide	https://fidlock.com/sites/default/files/MINI_TURN-thread-assembly_guide.pdf

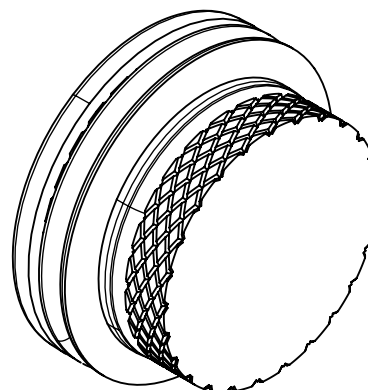

Article No	02055
Scale	1:1
Date	09.11.2021
Author	AB