

ASSEMBLY GUIDE

COINTRAP general information

FIDLOCK®

The FIDLOCK COINTRAP system



ASSEMBLY GUIDE

COINTRAP product family for helmets



female



COINTRAP helmet 15 UN



COINTRAP
helmet 15 UN divider

male



COINTRAP male M UN

additional



TRI GLIDE helmet 15



COINTRAP Endcap 15



Helmet Divider -
tunnel loop



COINTRAP male 15
cover+integrated pull tab

SET article numbers

- COINTRAP helmet 15 UN (male+female)
07072-000002 (BLK)
- COINTRAP helmet 15 UN divider
(male+female)
07076-000002 (BLK)

single article numbers

- TRI GLIDE helmet 15
07075-000002 (BLK)
- COINTRAP Endcap 15
07072-EC0002 (BLK)
07072-EC0002 (RED)
- Helmet Divider - tunnel loop
07061-000002 (BLK) (1,2 mm webbing)
07061-000012 (BLK) (0,8 mm webbing)
- COINTRAP male 15 cover+integrated pull tab
07072-EC1012 (not for helmets)

ASSEMBLY GUIDE

COINTRAP general information



how COINTRAP works



The tunnel loop and tri-glide are available from FIDLOCK. It is possible to use existing parts of open molds.

ASSEMBLY GUIDE

COINTRAP general information



how COINTRAP works

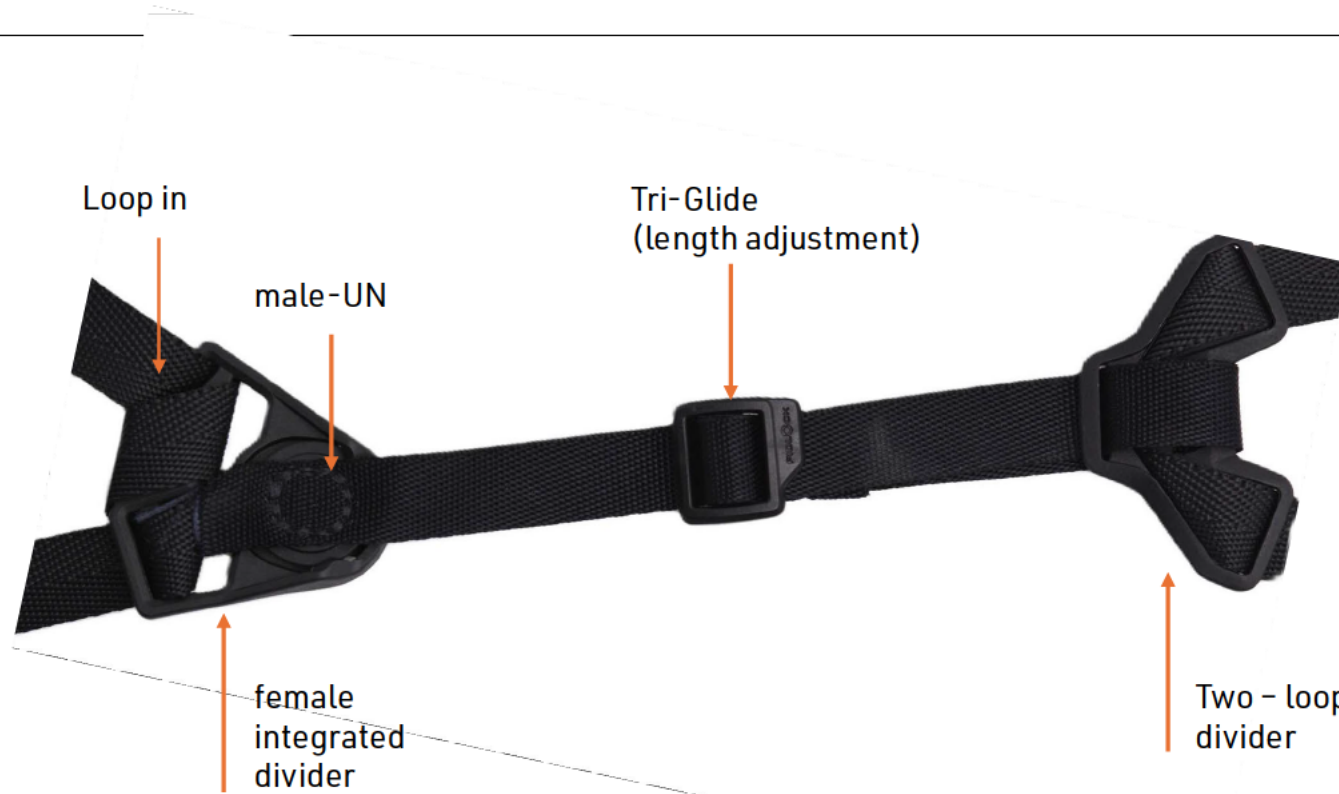

Tri-Glide is available from FIDLOCK. The two-loop divider is a part of open mold.

ASSEMBLY GUIDE

COINTRAP

general information



webbing assembly

Tunnel-Loop



Tri-Glide

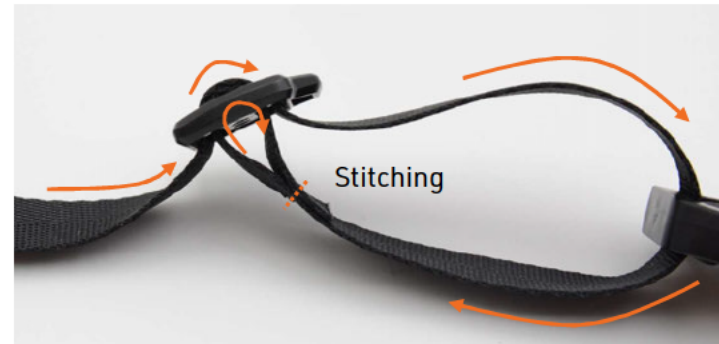

ASSEMBLY GUIDE

COINTRAP

helmet 15 UN male



assembly/sewing

OPTION 1: We suggest to use a computerized pattern sewing machine for the sewing of the COINTRAP UN male part. For example:

- ML-E3020R
- HuaLingHL-2516F/HL-3520F/HL-3520F

or bigger sizes:

- JinLing2516G/3020G/3520G
- XingChiXC-2516G/XC-3020G/XC3025
- ZOYER ZY-210A.

OPTION 2: Sewing with bartacking sewing machine (any brands)

It is crucial to use a correct work clamp and feed plate for fixing the male part during the sewing process. Dummy-data (STEP files) for machining/printing the work clamp can be provided by FIDLOCK.

Please contact your responsible FIDLOCK sales representative to get the data.

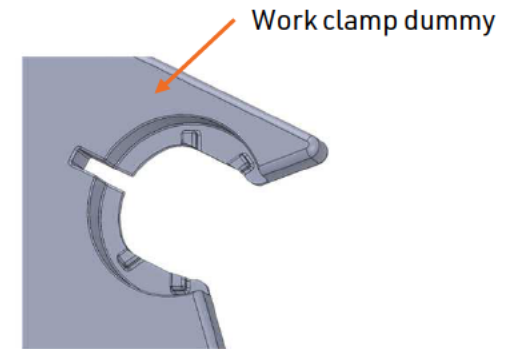

ASSEMBLY GUIDE

COINTRAP
helmet 15 UN male



assembly/sewing

ATTENTION:

The sewing pattern is not symmetrical round!

- Make sure that the webbing is placed in correct position!
- Use the arrows on the upper coin surface as a reference for the direction of the webbing

Lower thread:

- Count the maximum number of sewed coins per bobbin
→ Set a lower limit to make sure there is always enough lower thread left on the bobbin!
(e.g. Brother bartacking machine option)

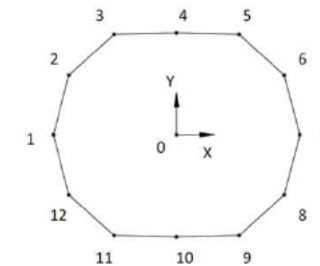
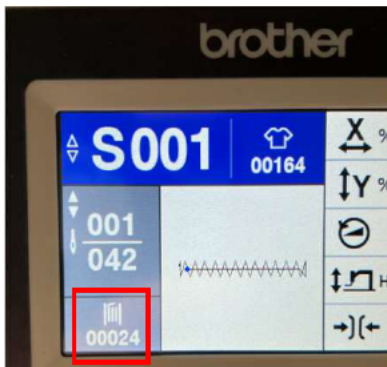
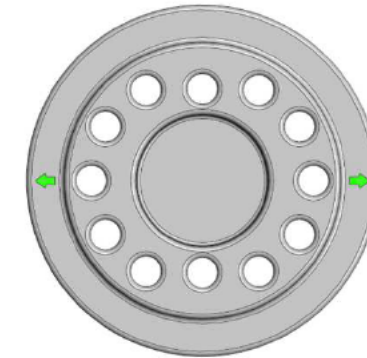

ASSEMBLY GUIDE

COINTRAP helmet 15 UN male



assembly/sewing

Recommended yarn : Amann Serafil 30, polyester multifilament, 90 tex (approx. 300 * 3 dtex/ Nm 33/3) or comparable yarn.

For helmet buckles : 4-stitching-cycles (48 stiches) are recommended to pass helmet regulations.

Backside with grooves for blankholder

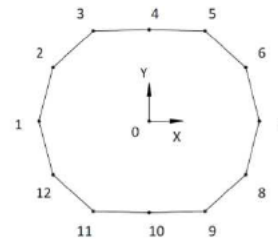
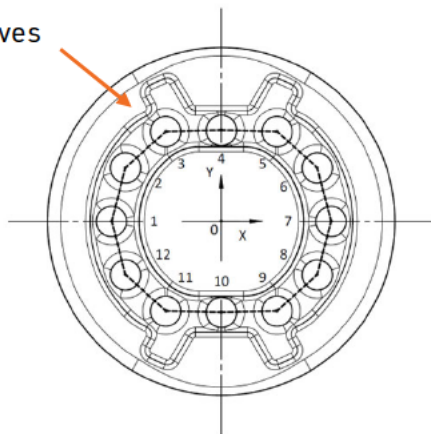

Position	X	Y
1	-7	0
2	-6,1	3,4
3	-3,5	5,7
4	0	5,8
5	3,5	5,7
6	6,1	3,4
7	7	0
8	6,1	-3,4
9	3,5	-5,7
10	0	-5,8
11	-3,5	-5,7
12	-6,1	-3,4

ASSEMBLY GUIDE

COINTRAP helmet 15 UN male



assembly

For ensuring a perfect working COINTRAP-System, FIDLOCK supports you and your manufacturer during the first sample production

To do so, FIDLOCK provides a small quality process including:

- Breaking load determination
- Webbing stiffness tests for flawless function

Contact your responsible FIDLOCK sales representative to obtain all necessary information.

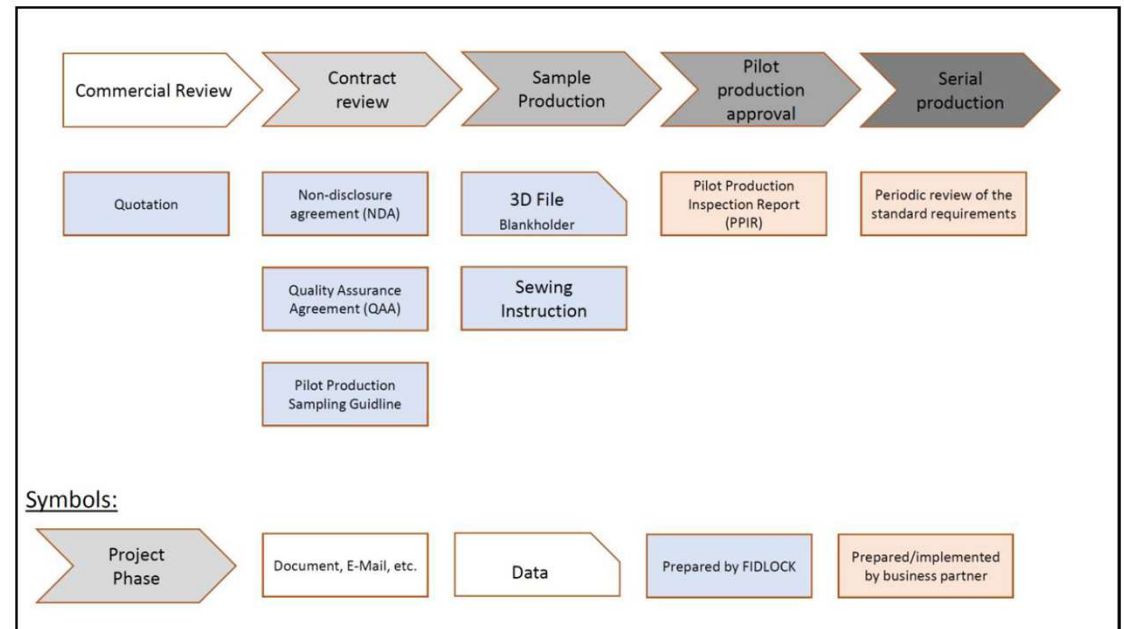

ASSEMBLY GUIDE

COINTRAP

general information



COINTRAP male 15 cover + Integrated pull tab

Assembly/sewing:

- Best results with thin needles and standard round points (R point)
- Coin needs to be sewn to the webbing first
- Afterwards it needs to be centric to the according position under the cover
- Maximum webbing length: 11 mm



PLEASE NOTE: Not for helmets!

ASSEMBLY GUIDE

COINTRAP

general information



COINTRAP male 15 cover + integrated pull tab

Assembly/sewing:

- After adding the pull tab to the webbing place it on the feed plate
- Add the work clamp
- Place it centric inside the machine
- Start the sewing

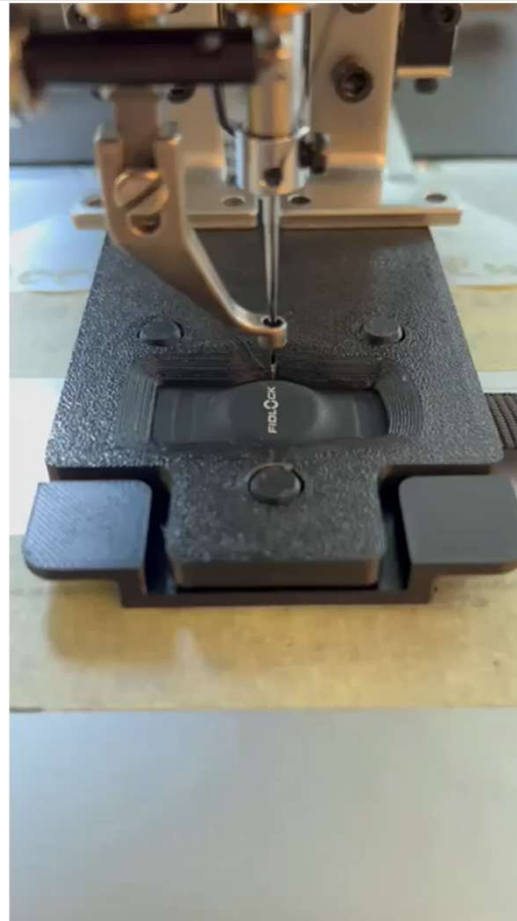

ASSEMBLY GUIDE

COINTRAP

general information



COINTRAP male 15 cover + integrated pull tab

Assembly/sewing:

- It is crucial to use a correct work clamp and feed plate for fixing the male part during the sewing process. Dummy-data (STEP files) for machining/printing the work clamp can be provided by FIDLOCK.

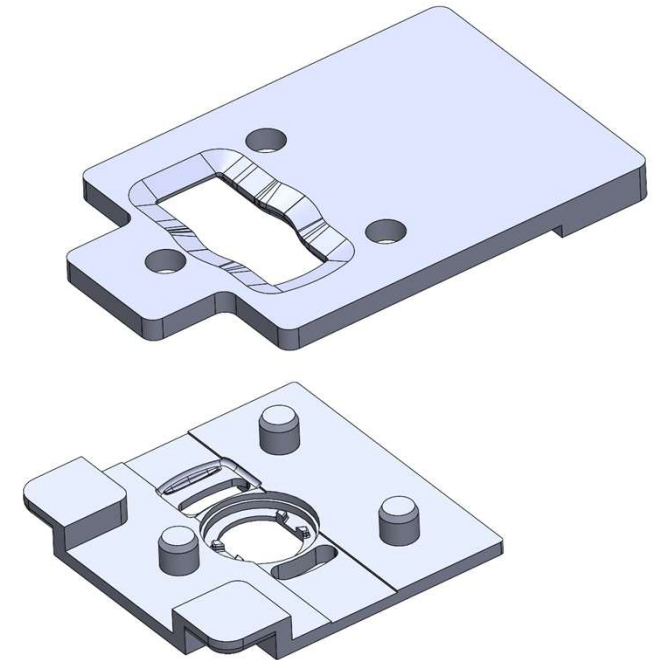

ASSEMBLY GUIDE

COINTRAP general information



COINTRAP male 15 cover + integrated pulltab

Coordinates for CNC programming

