

## Assembly Guide MINI TURN

To fit the fastener, you will need the following tools: scissors, a cutter, punch pliers, a fibre-tip pen, and a TOOL (TOOL 1 + TOOL 2, or TOOL 22, or TOOL 3, or a face spanner). The MINI TURN handle features a single-use catch mechanism and isn't removable after successful fitting! For prototypes and testing, it can be made removable by cutting off two catch hooks on the shaft of the handle (attention: the cut handle can no longer be used for production).

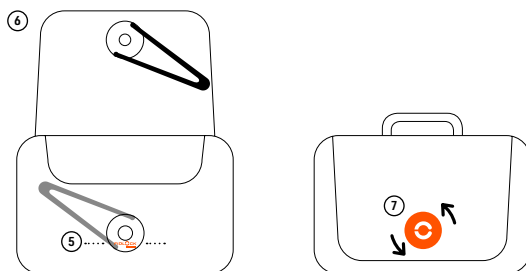
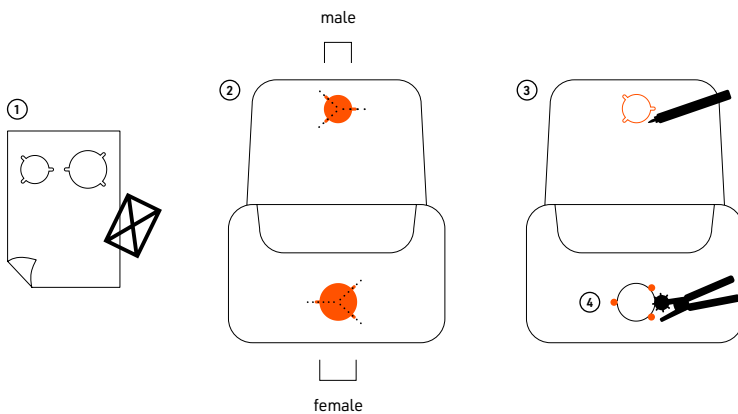
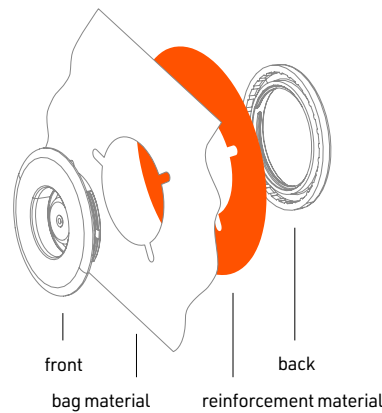
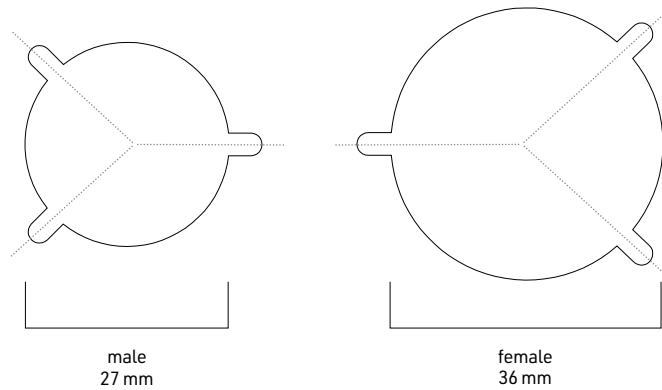

..... **FIDLOCK** .....  
 patented \*enlarged depiction

### 1. Fitting pattern / punching template (1:1)

- ⦿ Please download the pattern and punching template with the following link: [download.fidlock.com/Template\\_MINI\\_TURN\\_thread.zip](https://download.fidlock.com/Template_MINI_TURN_thread.zip)
- ⦿ Print the pattern and then cut it out.

### 2. Material and material reinforcement

- ⦿ If the bag material used is too floppy or too thin, cut out additional inlays for the female lower part and male upper part, e.g. out of cardboard, leather, or polypropylene, and place these between the fastener parts as reinforcement.
- ⦿ The thickness of the upper material, reinforcement materials and bag lining should be between 1,0 and 2,6 mm in total.

**Note**  
 The MINI TURN requires a material thickness of 1,0 to 2,6 mm.

### 3. Exact positioning and alignment

- ⦿ Cut out the patterns ① and place the male pattern on the bag flap and the female pattern on the body of the bag.
- ⦿ Next, use the fibre tip pen to mark the position on the material (fabric) ③ and cut or punch the holes into the material ④.

**Note**  
 The exact alignment of the eyes ② is essential to ensure the male and female closing mechanism works!

### 4. Fitting correctly

- ⦿ Fit the female lower fastener part ⑤ by screwing the back and front sections together by hand (see page 5 for details).
- ⦿ For the final tightening, insert TOOL 3 (face spanner) into the holes of the threaded ring and turn in a clockwise direction.
- ⦿ Fit the male upper fastener part ⑥ by screwing the front and back section together by hand. Then tighten with TOOL 3 (face spanner).

**Note**  
 The "FIDLOCK patented" logo will be correctly and horizontally aligned if the position of the eyes ② is punched correctly.

It is essential to ensure the exact alignment of the handle. To do so, turn the handle to the correct position (sticker/logo) and then click into place ⑦.