

add-on part, not included in the scope of delivery, please order separately :
Art no.: 01520-DP00021C

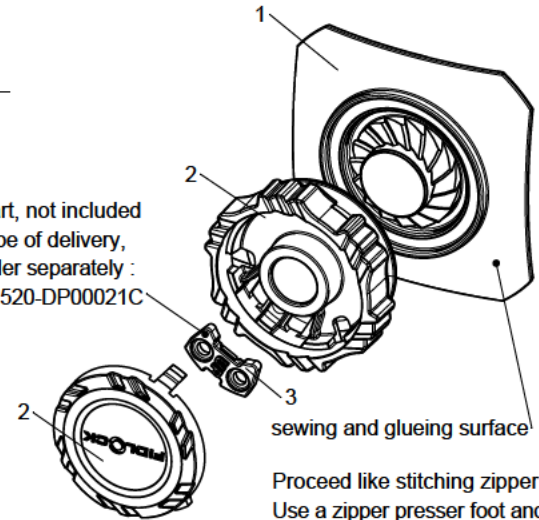

sewing and glueing surface

Proceed like stitching zipper
Use a zipper presser foot and stitch length 2-3mm
(For securing the thread we recommend choosing a position next to the Fidlock part. Otherwise stability could be reduced.)

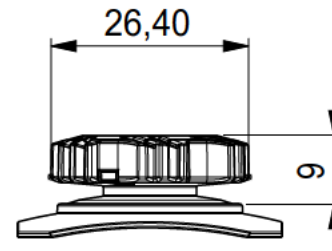
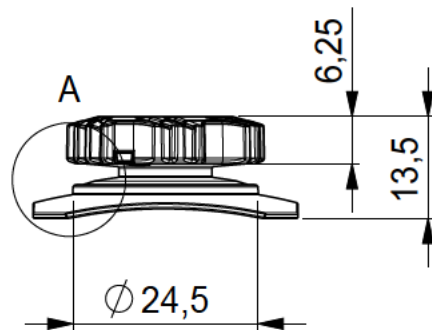

Fabric or Leather should not exceed this height!

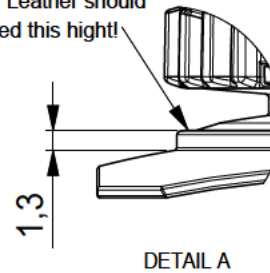

dimensions in millimeters [mm]

OPENING	Pull
MATERIAL	PA6 ¹ , PP ² , ABS ³ , NdFeB, Epoxy
COLOUR	Black (Base + Handle)
WEIGHT	6,9 g (weighed)
LOAD CAPACITY	160N

GENERAL NOTES*

Lace Diameter: 1.0 - 2.4mm -Lace Dependent
Lace Attachment : Knot
Delivery without Lace
Stitchable base
Washability max. 60 Degree

ARTICLE NO.	F1520
PRODUCT	Winch compact
SCALE	2:1
REVISION / DATE	R02 14.11.2023

Winch Compact handle

patented technology

** datasheet shows art.no. F1520-HR0022(BLK) -Direction of rotation clockwise-

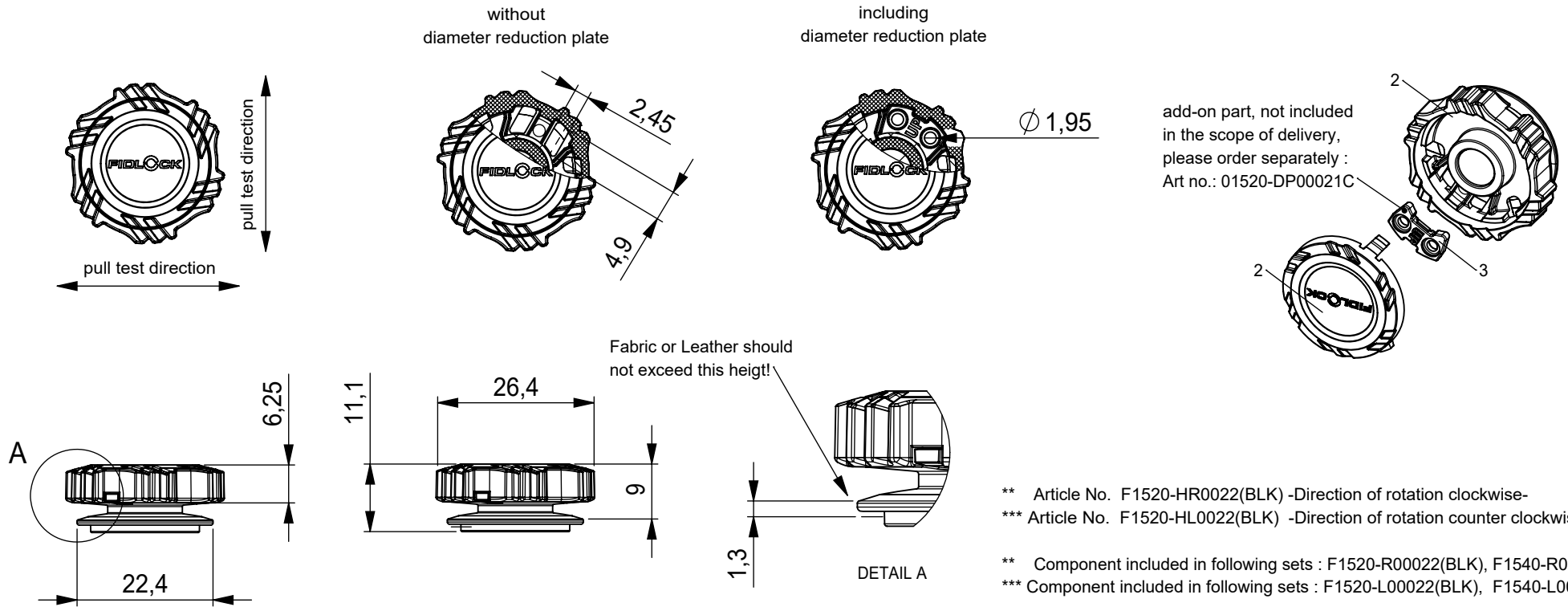

- ** Article No. F1520-HR0022(BLK) -Direction of rotation clockwise-
- *** Article No. F1520-HL0022(BLK) -Direction of rotation counter clockwise-
- ** Component included in following sets : F1520-R00022(BLK), F1540-R00022
- *** Component included in following sets : F1520-L00022(BLK), F1540-L00022

nominal values in millimeters [mm]

OPENING	Pull
MATERIAL	PP ² , ABS ³ , NdFeB
COLOUR	Black (Handle)
WEIGHT	~ 4.2 g (weighed)
BREAKING LOAD**	160 N

GENERAL NOTES*

Lace Diameter 1 - 2.4mm -Lace Dependent
 Lace Attachment : Knot
 Delivery without Lace

Washability max. 60 Degree

ARTICLE NO.	F1520
PRODUCT	Winch compact handle
SCALE	1:1 DIN A4
REVISION / DATE	R02 15.11.23

* The manufacturer of the end products in which FIDLOCK fasteners are used, bears the responsibility for thoroughly testing that the FIDLOCK products are suitable for the intended applications.